

1

← \varnothing 2x5 x3
13.5 mm
← \varnothing 2x8 x6
N2x4
← \varnothing 2x5 x4
B6x13x5 x4

2 本圖組裝方式以單側組裝示意。
This picture only shows one side of carbon frame.

← \varnothing 2x8 x12
M2x4 x4
M2x4 x2
← \varnothing 2x5 x6

3

←W2x3.5x0.5 x2
←B2x5x2.5 x4
←M2x10 x2
 \varnothing 2x8 x2
M2x10 x2

4

螺絲均需上止滑劑
All Screws on side plates should be applied with thread locker.

M2x5 x4
M3x5 x4
M2x12
W2x5x0.5
N2x4
M2x8 x2
M2x5

Tips

5

W5x9x0.2 x2
W5.1x9x1.1 x2
W5.1x7x0.12 x2
M2x8 x1
Oring x2
M3x6 x2
W3x8x1 x2
T5x10x4 x2
M2.5x12
B5x9x3 x4
N2.5x5
Long ball head screw
長球頭
T5x10x4
Bigger inner race 內徑較大
Smaller inner race 內徑較小
Top: longer distance to the notch
平面離洞口處較遠朝上

5-1

螺絲均需上止滑劑
All Screws on side plates should be applied with thread locker.

W2x3.5x0.5
B2x5x2.5 x8
W2x3.5x0.5 x10
M2x10 x4

6

Short ball head screw
短球頭
M2x3.2 x4
Long ball head screw
長球頭
←B20x27x4
← \varnothing 2x3.5 x3

螺絲均需上止滑劑
All Screws on side plates should be applied with thread locker.

7

螺絲均需上止滑劑
All Screws on side plates should be applied with thread locker.

Washer
10.2x13.5x0.1
M2x4 x8
Counter threaded (you should assemble the two part from the usual opposite direction).
逆牙方向鎖入
Note: Clip to belt gear
皮帶需扣上齒盤

8

③
 \varnothing 2x8
①
②

9

P1.5x10.8
M2x2
M2x4 x2
B4x8x3 x2
M2x4 x2
 \varnothing 2x14 x2
← \varnothing 2x5 x1
M2.6x3.7 x2
B3x6x2.5 x2
M2x14

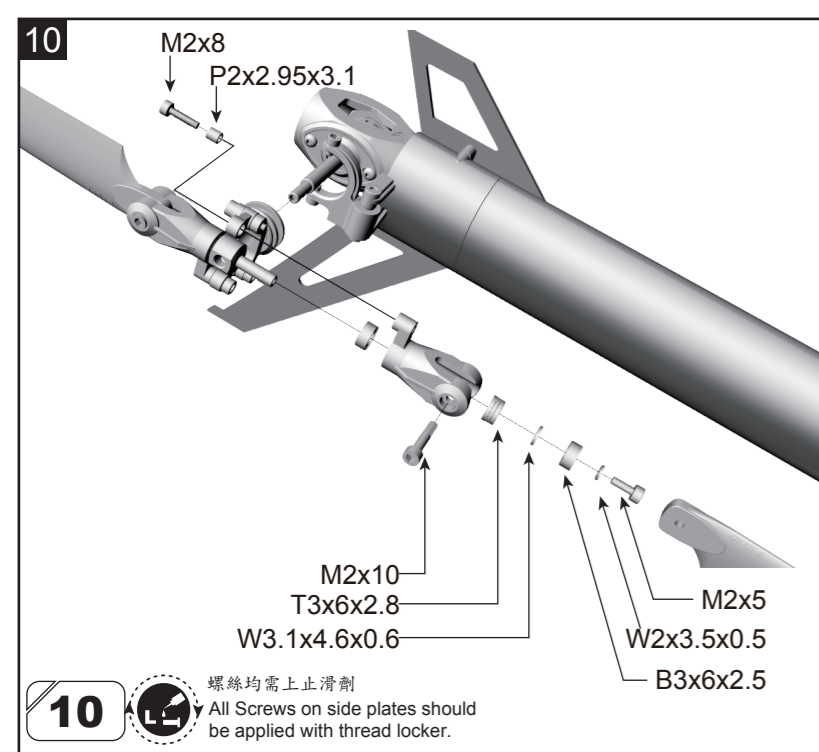

10 螺絲均需上止滑劑
All Screws on side plates should be applied with thread locker.

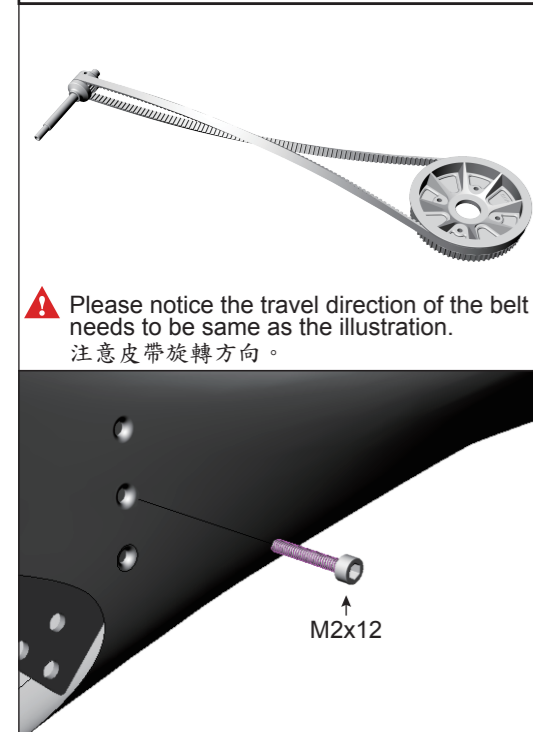

! Please notice the travel direction of the belt needs to be same as the illustration.
注意皮帶旋轉方向。

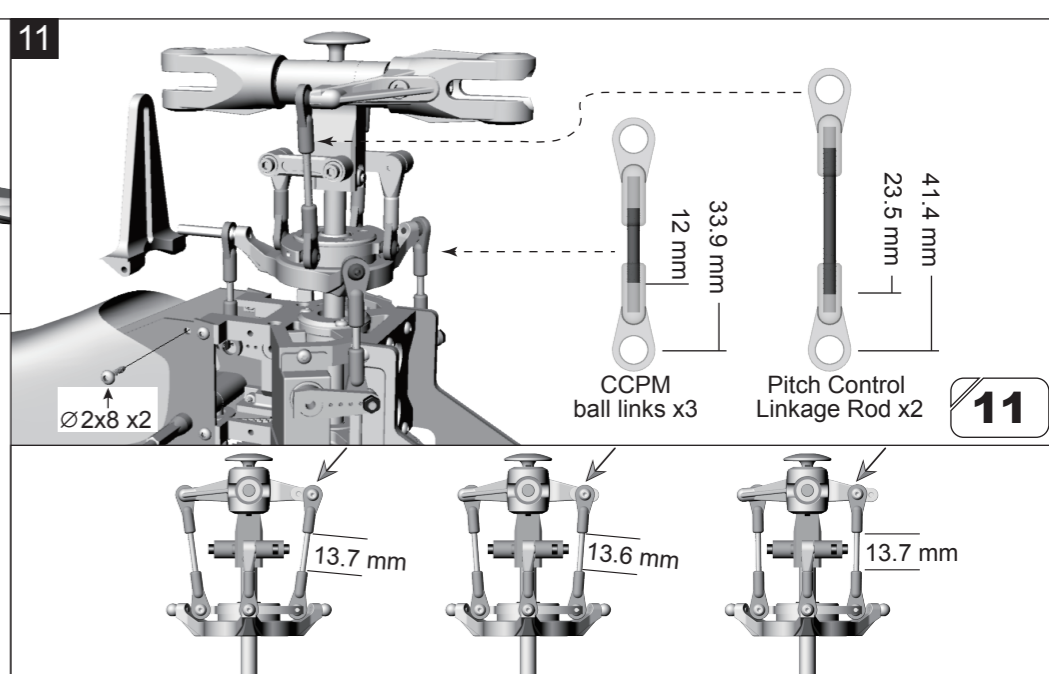
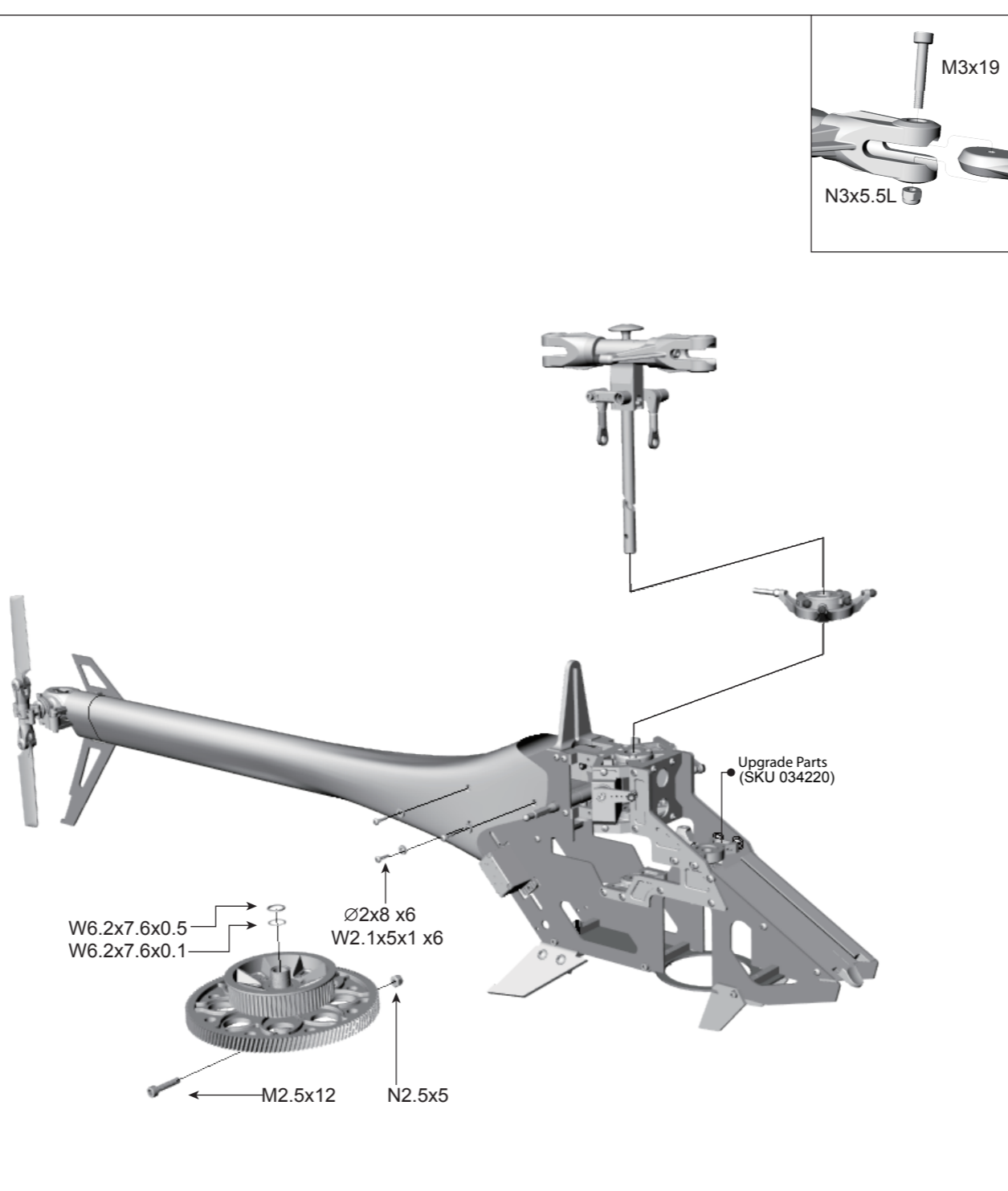

Different ball head installation on grip lever affects flight response, adjust position according to pilot own preference. However the same position must be selected for both grip levers.
不同的球頭位置會影響飛行的反應速度，請依個人需求調整適當的位置。主旋翼槳夾的球頭需同位置。

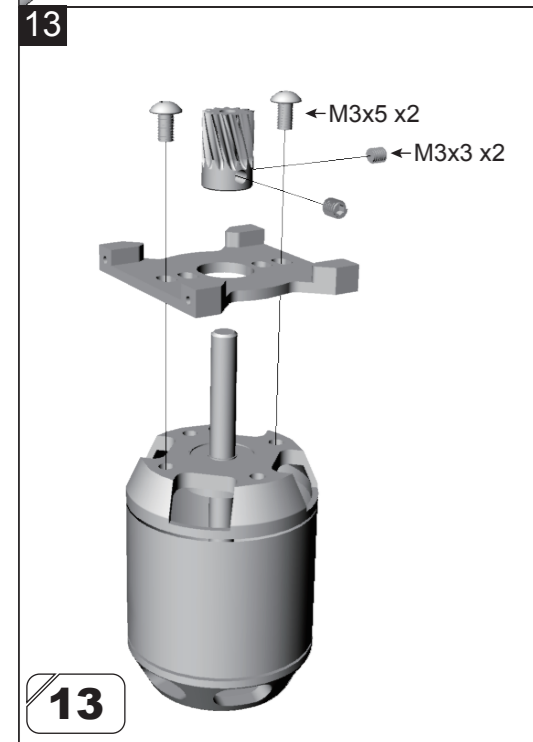
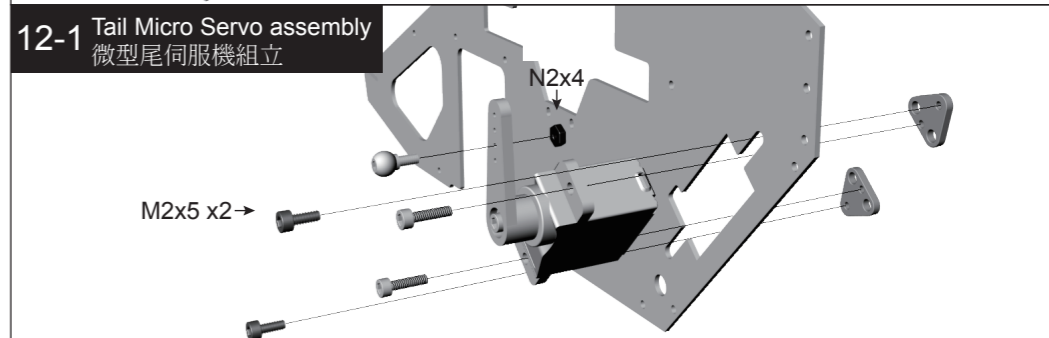
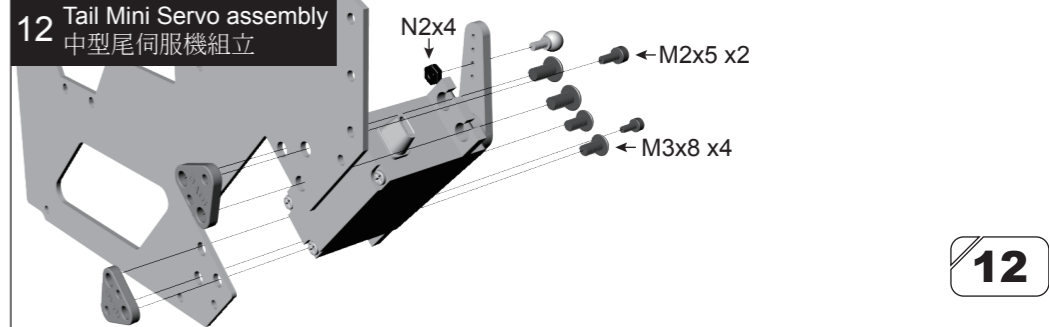

13



One can use a small strip of paper to adjust the pinion / main gear mesh to be around 0.1mm.
可使用1張紙滾入齒輪之間調整間隙為0.1mm。

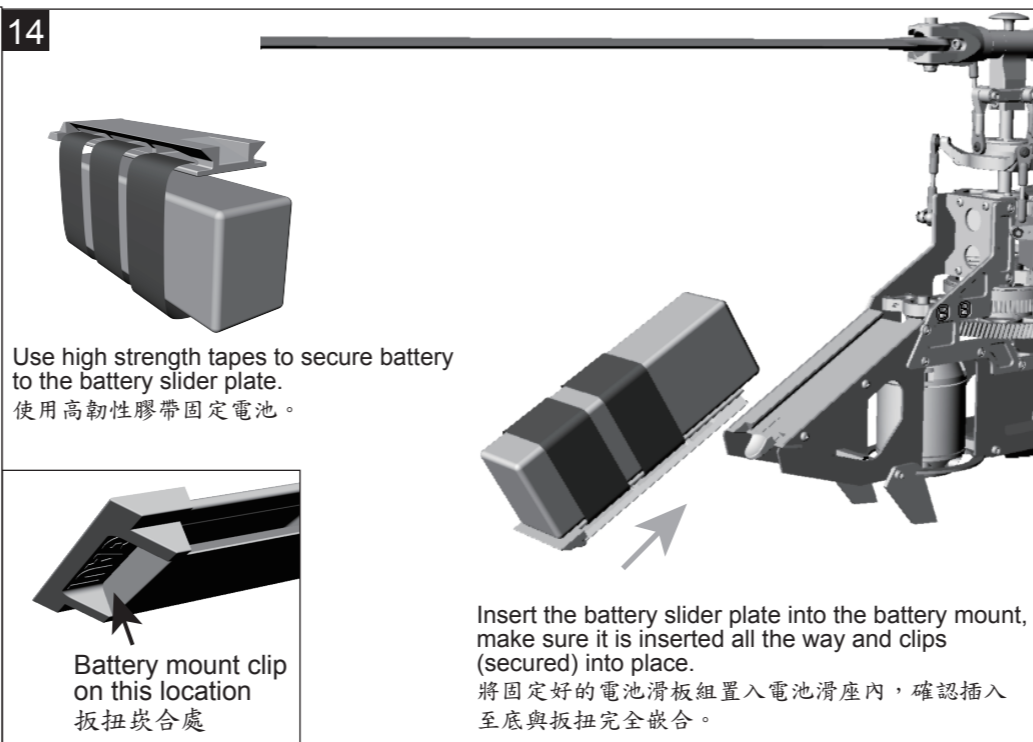

14 Use high strength tapes to secure battery to the battery slider plate.
使用高韌性膠帶固定電池。

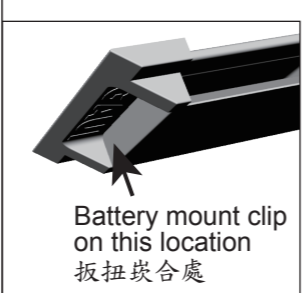

Battery mount clip on this location
扳扭嵌合處



Insert the battery slider plate into the battery mount, make sure it is inserted all the way and clips (secured) into place.
將固定好的電池滑板組置入電池滑座內，確認插入至底與扳扭完全嵌合。

We highly recommend every customer get the latest manual from our website by scanning the QR CODE.
This product is for a radio controlled (RC) helicopter. Improper operation, maintenance or assembly can potentially cause a RC helicopter to pose a danger to persons or objects including but not limited to the possibility of causing serious physical injury and even death.
我們建議您掃描 **QR CODE** 下載最新手冊。
本產品是無線遙控的直升機，不當的操作，保養或是組裝有可能導致遙控直升機對於人身或是物品造成危險。包括，但是不局限於對於人體產生嚴重傷害甚至死亡的可能性。

