

10 螺絲均需上止滑劑
All Screws on side plates should be applied with thread locker.

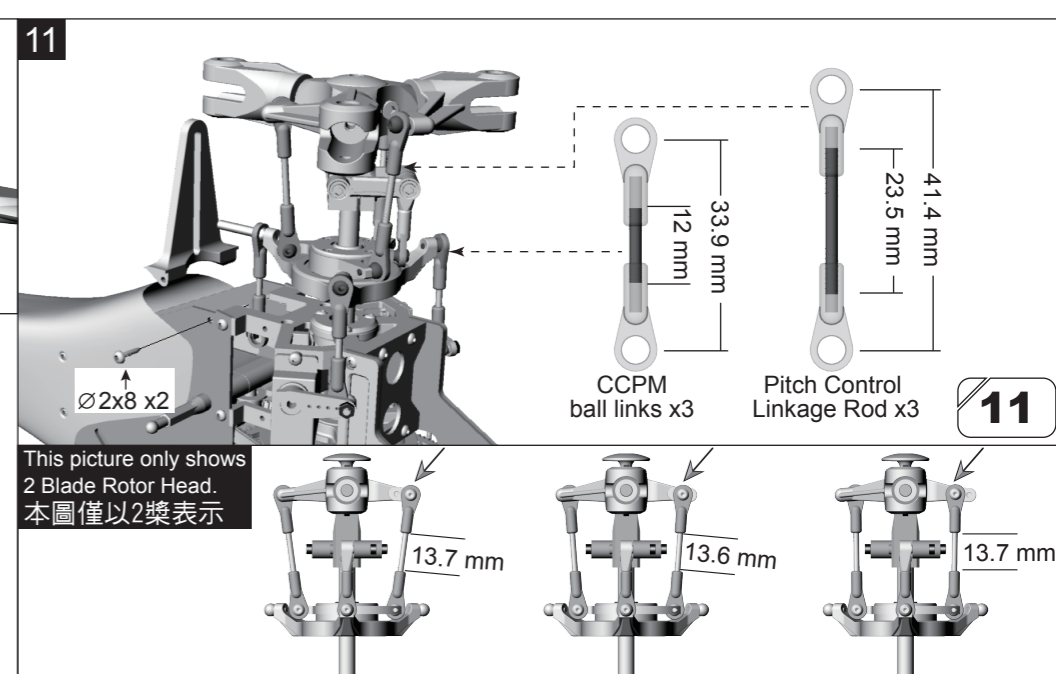

This picture only shows 2 Blade Rotor Head.
本圖僅以2槳表示

Different ball head installation on grip lever affects flight response, adjust position according to pilot own preference. However the same position must be selected for both grip levers. 不同的球頭位置會改變飛行的反應速度，請依個人需求調整適當的位置。主旋翼槳夾的球頭需同位置。

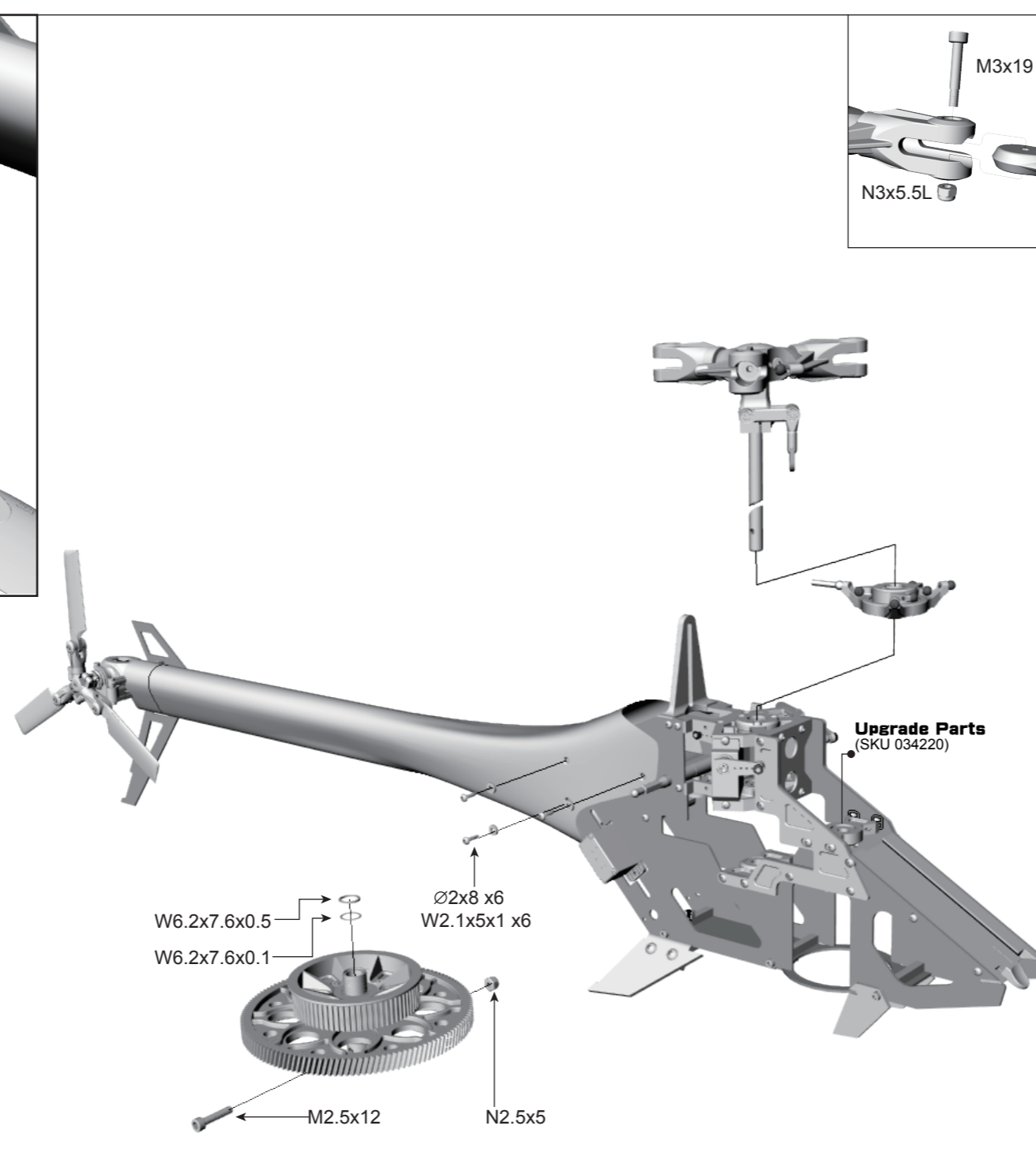
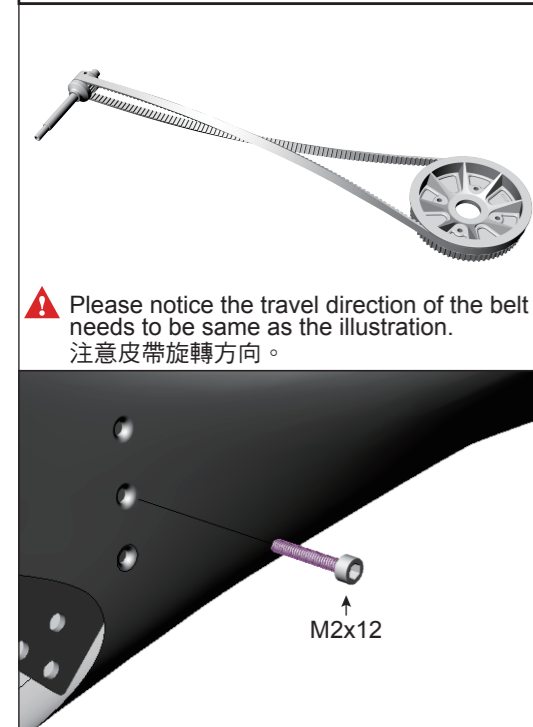
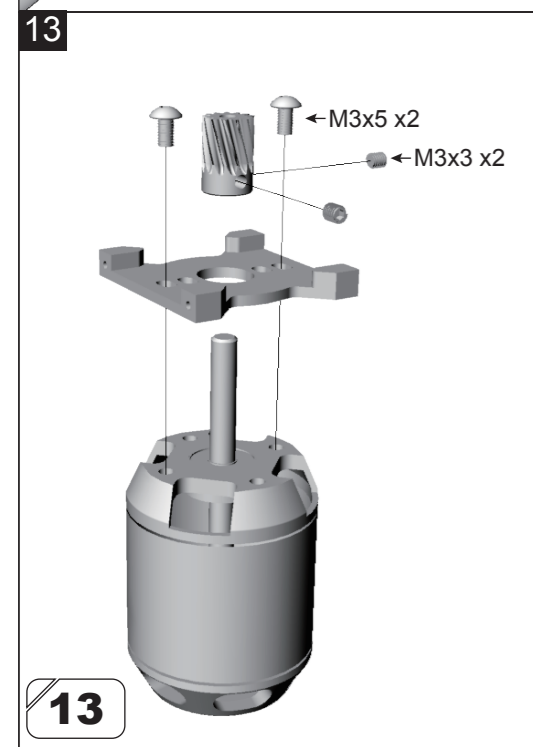
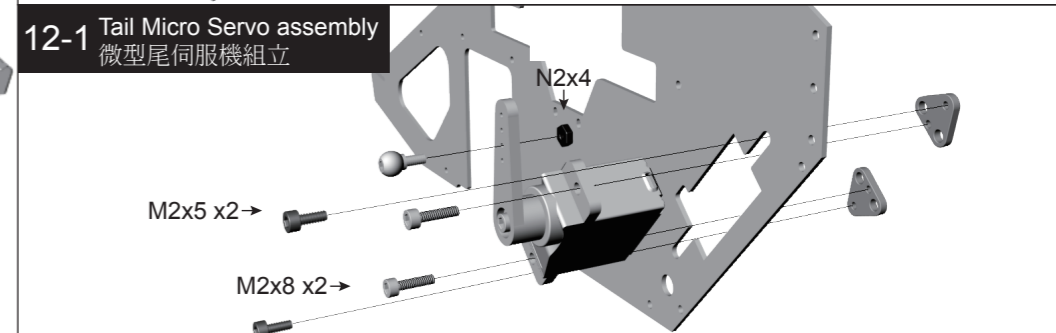
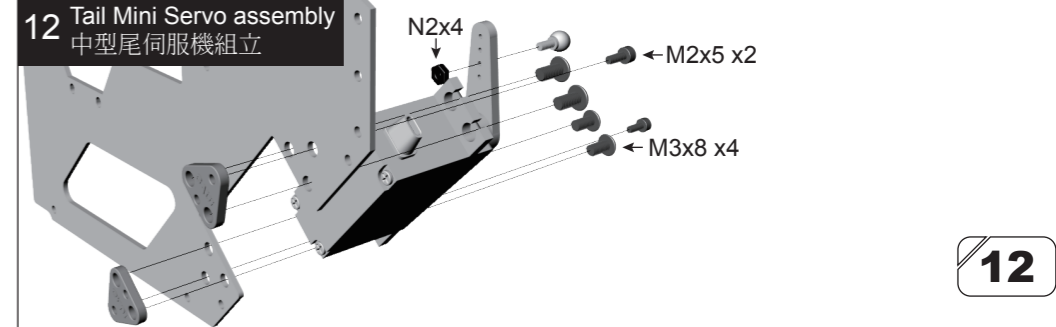

One can use a small strip of paper to adjust the pinion / main gear mesh to be around 0.1mm.
可使用1張紙滾入齒輪之間調整間隙為0.1mm。

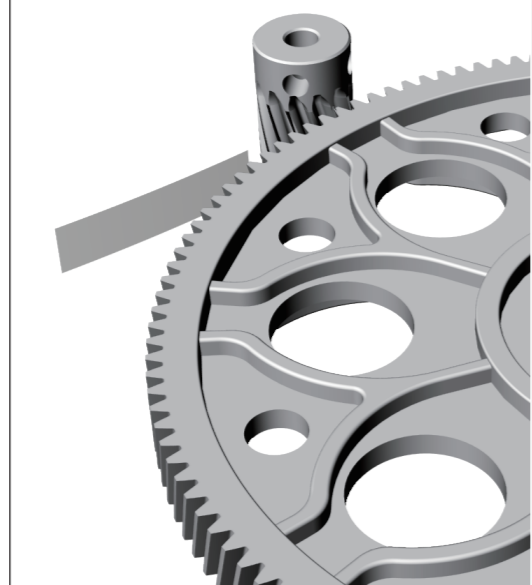

Manual

We highly recommend every customer get the latest manual from our website by scanning the QR CODE. This product is for a radio controlled (RC) helicopter. Improper operation, maintenance or assembly can potentially cause a RC helicopter to pose a danger to persons or objects including but not limited to the possibility of causing serious physical injury and even death. 我們建議您掃描 QR CODE 下載最新手冊。本產品是無線遙控的直升機，不當的操作，保養或是組裝有可能導致遙控直升機對於人身或是物品造成危險。包括，但是不局限於對於人體產生嚴重傷害甚至死亡的可能性。